

3GSDI Extender via One LC Singlemode or Multimode Fiber Optic Cable

XTENDEX®

Extend a SD/HD/3G-SDI display up to 12.4 miles (20 kilometers)

- Signal transmission via one singlemode or multimode LC fiber optic cable.
 - Using singlemode 9-micron cable, extend to 12.4 miles (20 kilometers).
 - Using multimode 50-micron cable, extend to 1,640 feet (500 meters).
- Supports HDTV resolutions to 1080p @60Hz.
- Simultaneously transmits to two SD/HD/3G-SDI displays at the receiver.
- Supports a local display via loop out SDI connector.
- Supports unidirectional RS485 from the receiver to the transmitter.
- Plug-and-play functionality – no software needed.
- Low RFI/EMI for sensitive applications.
- Cables can be installed in conduit prior to extender installation.
- Integrated mounting brackets for easy surface/wall mounting.
- Available power options: 5VDC or 12VDC



**XTENDEX® ST-1F03GSDI-LC
(Local and Remote Unit)**



The XTENDEX® SD/HD/3G-SDI Extender via Fiber Optic Cable locates up to two displays from a SD/HD/3G-SDI video source up to 12.4 miles (20 kilometers) away using a single singlemode LC fiber optic strand and 1,640 feet (500 meters) using multimode fiber optic cable. Each extender consists of a transmitter that connects to a SD/HD/3G-SDI video source and a local loop out, and a receiver that connects to up to two SD/HD/3G-SDI displays.

Configuration and Cable Illustration

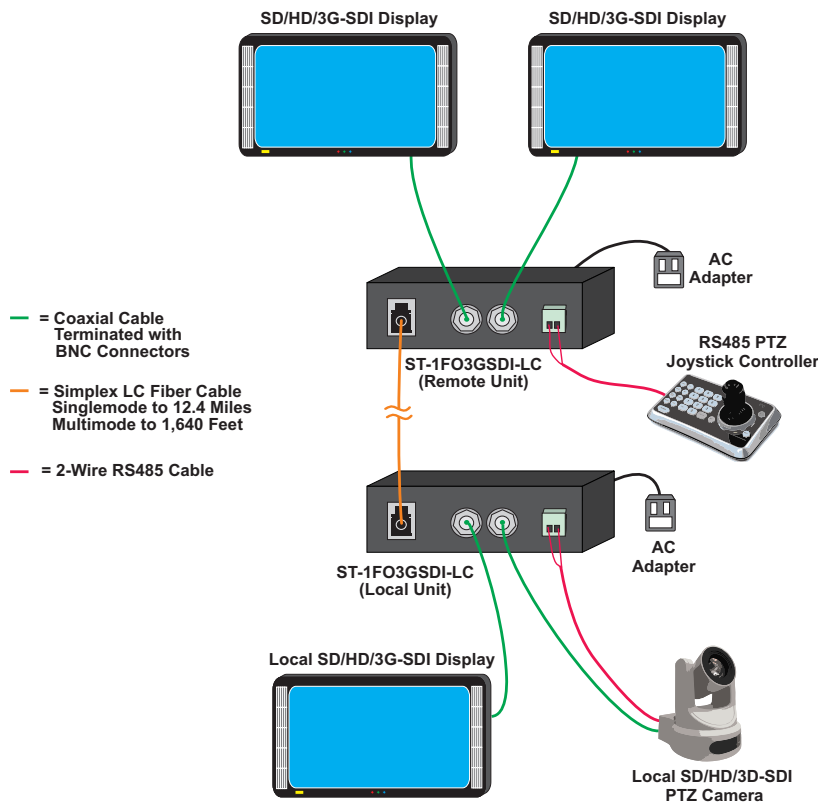

3GSDI Extender via One LC Singlemode or Multimode Fiber Optic Cable

XTENDEX®

Extend a SD/HD/3G-SDI display up to 12.4 miles (20 kilometers)

Specifications

Local Unit

- One female 75 ohm BNC connector for SD/HD/3G-SDI video input.
- One female 75 ohm BNC connector for local SD/HD/3G-SDI loop out video output.
- One female LC fiber connector.
- One 2-pin terminal block for RS485.

Remote Unit

- Two female 75 ohm BNC connector for SD/HD/3G-SDI video output.
- One female LC fiber connector.
- One 2-pin terminal block for RS485.

Video

- Supports HDTV resolutions to 1080p @60Hz.
- Protocols supported: SMPTE 292M, SMPTE 424M, SMPTE 425M
- Supports NTSC and PAL video.

RS485

- Supports unidirectional RS485 from the receiver to the transmitter.
- Baud rate: 1200, 9600, 115200

Power

- ST-1FO3GSDI-LC Local and remote unit:
 - Input: 100 to 240 VAC at 50 or 60Hz via AC adapter (included).
 - Output: 5VDC, 3A
 - Power consumption: 2.5W
- ST-1FO3GSDI-LC12V Local and remote unit:
 - Input: 100 to 240 VAC at 50 or 60Hz via AC adapter (included).
 - Output: 12VDC, 1A
 - Power consumption:
 - ◆ Local unit: 2.52W
 - ◆ Remote unit: 2.16W

Dimensions

- Local and remote unit WxDxH: 4.81x4.11x1.13 in (122x104x29 mm)

Environmental

- Operating temperature: -4 to 131°F (-20 to 55°C).
- Operating and storage relative humidity: 0 to 95% non-condensing RH.

Regulatory Approvals

- CE, FCC, RoHS

Warranty

- Two years

Max Distance

- 12.4 miles (20 km) over singlemode 9/125-micron LC simplex fiber optic cable.
- 1,640 feet (500 meters) over multimode 50/125-micron (OM2/OM3/OM4) LC simplex fiber optic cable.

Cables

- Interface cables (RG6) between the video source/display and the transmitter/receiver are required for proper operation.
 - Maximum RG6 cable distance:
 - ◆ 3G-SDI: up to 328 ft (100 m)
 - ◆ HD-SDI: up to 656 ft (200 m)
 - ◆ SD-SDI: up to 984 ft (300 m)
- Use a simplex LC singlemode 9/125-micron fiber optic cable to extend the receiver from the transmitter up to 12.4 miles (20 kilometers).
- Use a simplex LC multimode 50/125-micron (OM2/OM3/OM4) fiber optic cable to extend the receiver from the transmitter up to 1640 feet (500 meters).
- Cables not included.

Compatible NTI Products

- Combine NTI's converter for complex applications.
 - 3G-SDI to HDMI with Audio Converter Scaler (3GSDI-HDA)

3GSDI Extender via One LC Singlemode or Multimode Fiber Optic Cable	
NTI Part #	Power Output
ST-1FO3GSDI-LC	5VDC, 3A
ST-1FO3GSDI-LC12V	12VDC, 1A