

ST-IPUSBVD-VW

Stream & Videowall Management 1.6 user manual for Android

INDEX

System Requirement	1
Google Play Download Link.....	1
Before APP Installation.....	1
Basic Operation	2
Home Screen	2
Add Clients	2
Add Hosts	5
Select Client Channel.....	8
Client Management	9
Set Client Info	9
Delete Client	11
TV Wall Management.....	12
Reboot Client	16
Set IP Mode	17
Auto Mode	17
DHCP Mode	17
Static IP	18
Set Factory Default	20
Launch Web.....	21
Indicator	22
Host Management	23
Preview Image	23
Set Host Info	24
Delete Host	26
Reboot Host.....	27
Set Host Channel.....	28
Set IP Mode	29
Auto Mode	29
DHCP Mode	29
Static IP	30
Set Factory Default	32
Launch Web.....	33
Indicator	34
Group Management.....	35
Create Group	35
Select Group Channel.....	37
Edit Group Info.....	39
Delete Group	41

Stream & Videowall Management 1.6 user manual for Android

System Requirement

APP name: Stream & Videowall Management

Ver. 1.6



Android version 4.1 or later

Size: 2.12M

Google Play Download Link

<https://play.google.com/store/apps/details?id=com.sct.sctcontrolcenter1>

Google Play Download QR code



Before APP Installation

You have to connect the Host (TX) / Client (RX) / Ethernet Switch / Access Point (Wi-Fi router) together. Connect your mobile phone by Wi-Fi and set the IP address at same subnet as the Host / Client. The System default IP setting is Auto IP, it will assign 169.254.X.X (subnet mask 255.255.0.0) to hosts and clients. You can also set to DHCP or Static IP. Refer to the user manual's web setting chapter: IP Setup.

Methods get the IP address of receiver:

1. Connect monitor with receiver, **local IP** shows on right bottom screen when receiver is booting without the transmitter connected (or no video input)
2. Press remote control button **MENU, 1, ENTER** (Network Information). The receiver IP Address will be displayed on the screen

Methods get the IP address of transmitter:

1. Connect monitor with receiver, connect receiver with transmitter and set in the same channel. The **remote IP** address will display on right bottom of the screen when receiver is booting with no video input from transmitter.

Set IP address of transmitter/receiver by command:

Press and hold panel button "+" then power ON to set factory default then enter engineering mode. In engineering mode "ON" and "Link" LEDs will flash together, IP address of unit will be set to Static IP 192.168.0.88 temporarily. Log in to the web page by browser and change IP settings in API commands column as below(x can be one of numbers 1~254):

```
astparam s ip_mode static
astparam s ipaddr 169.254.x.x
astparam s netmask 255.255.0.0
astparam save
```

Commands can be applied one by one, or connected by ";" to apply all at once enter as below:

```
astparam s ip_mode static;astparam s ipaddr 169.254.x.x;astparam s netmask 255.255.0.0;astparam save
```

Also you could use private IP address/subnet mask you prefer like 192.168.x.x/255.255.255.0

Stream & Videowall Management 1.6 user manual for Android

Basic Operation

Home Screen

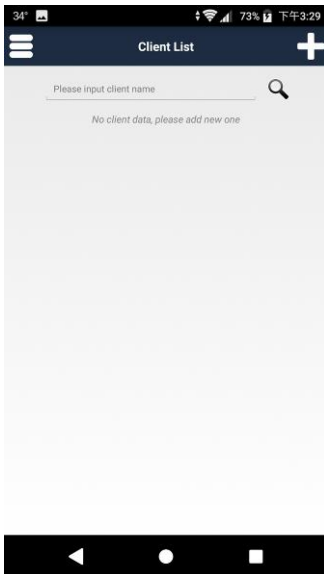

It will show Client List page when entering the APP. Touch top right 「+」 to enter Add Client page

Add Clients

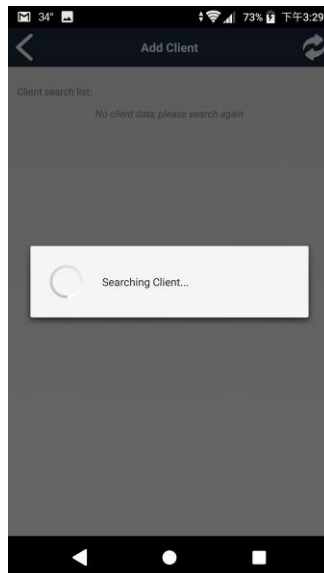

After touching 「+」 it will start searching for clients

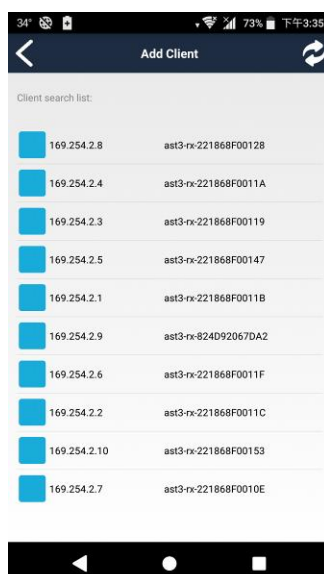

It will show all clients with pure blue icon in the list
Touch IP address to enter client information

Stream & Videowall Management 1.6 user manual for Android

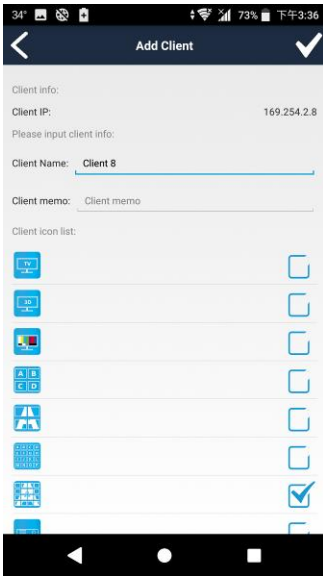

Enter the client name and memo, select the icon you prefer
Touch top right 「✓」 button to finish setting.

Notice: Client name must be unique (no duplicates)

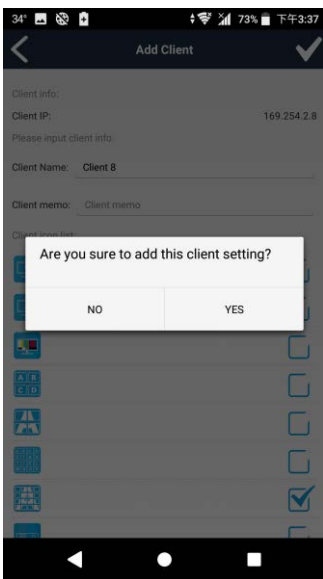

Touch 「Yes」 to confirm setting

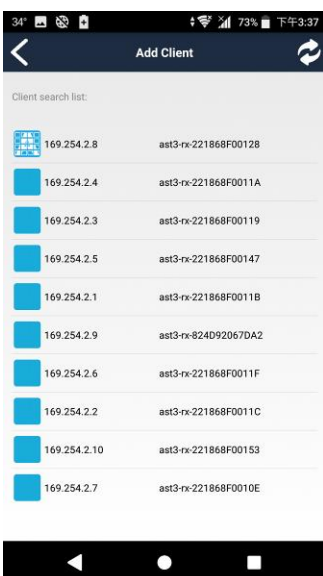

Returning to Add Client page you will see the icon you selected in front of the client you just added.

Stream & Videowall Management 1.6 user manual for Android

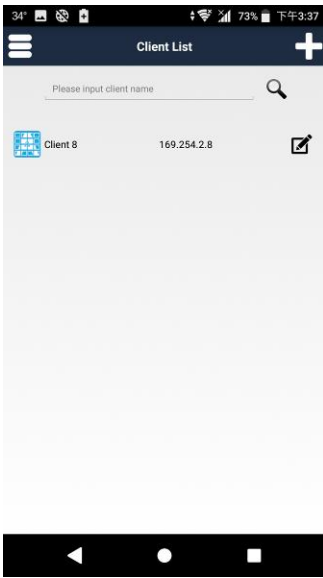

Return to the Client List page to see the client which you just added.

Stream & Videowall Management 1.6 user manual for Android

Add Hosts

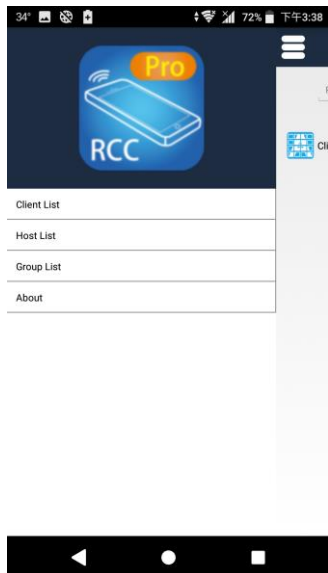

Touch top left menu bar on Client list to show the full menu.
Touch Host List.

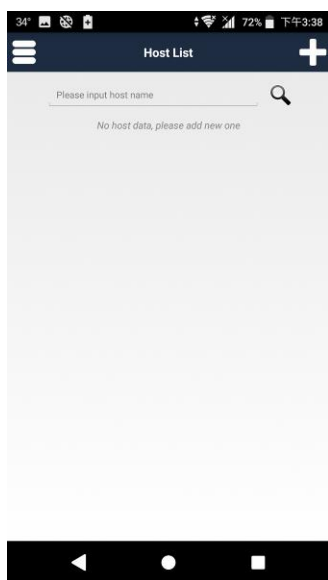

Touch top right 「+」 to enter Add Host page

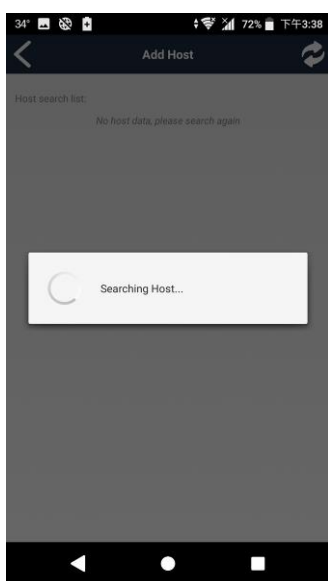

After touching 「+」 it will start search for hosts

Stream & Videowall Management 1.6 user manual for Android

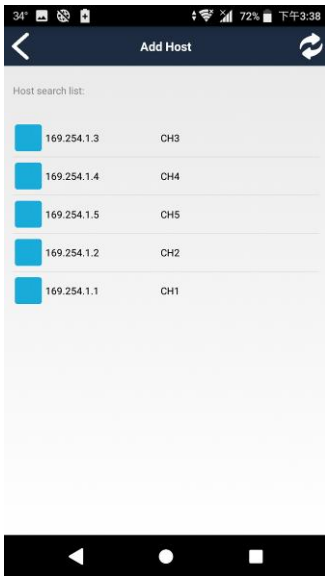

It will show all hosts with pure blue icon in the list.
Touch IP address to enter the host information

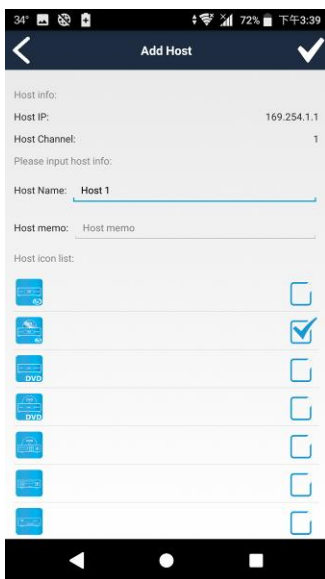

Enter the host name and memo, select the icon you prefer
Touch top right 「✓」 button to finish setting.
Notice: Host name must be unique (no duplicates)

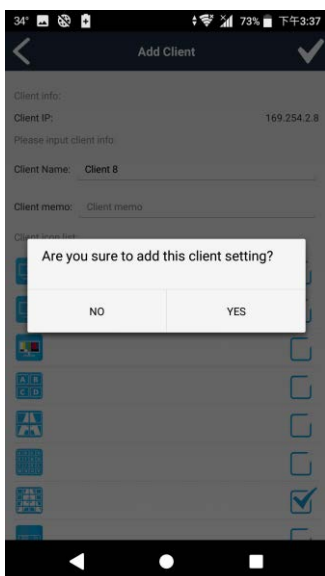

Touch 「Yes」 to confirm settings

Stream & Videowall Management 1.6 user manual for Android

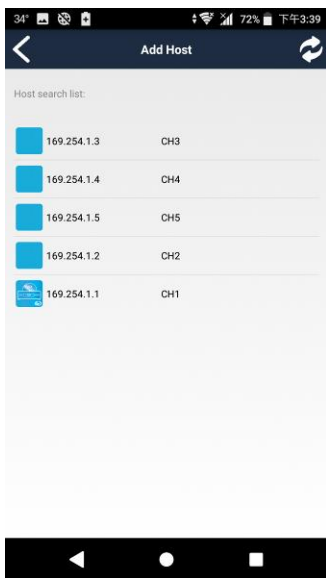

Return to Add Host page to see the icon you selected in front of the host just added.

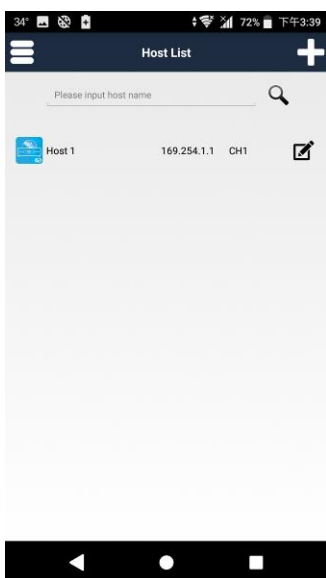

Returning to the Host List page you will see the host just added.

Stream & Videowall Management 1.6 user manual for Android

Select Client Channel

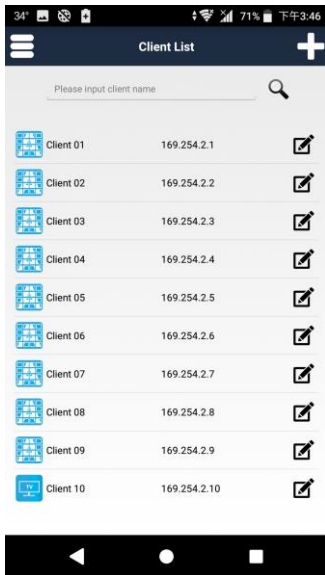

Left: Icon and name of clients
Center: IP address of clients
Right: client management (pencil icon)

Touch a client in the left column to enter Client Source page

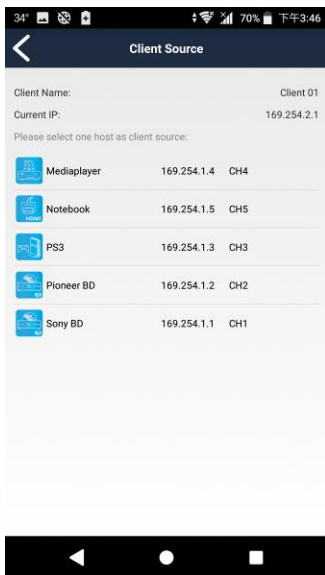

In Client Source page it will list all registered hosts available for selection

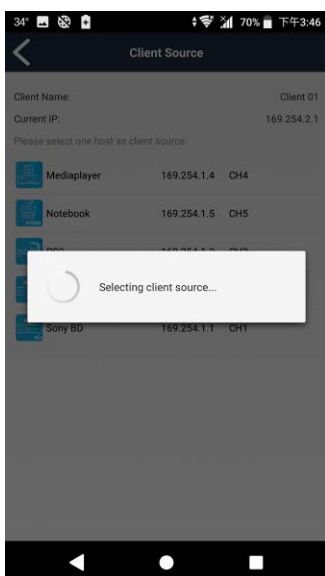

Touch the host icon to select it.
The selected channel will be switched to immediately

Stream & Videowall Management 1.6 user manual for Android

Client Management

Set Client Info

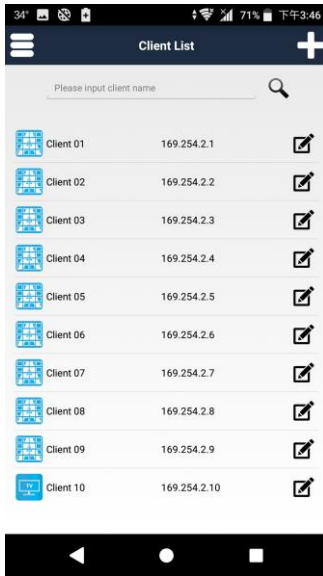

Touch right pencil icon in client list to enter Client Management page

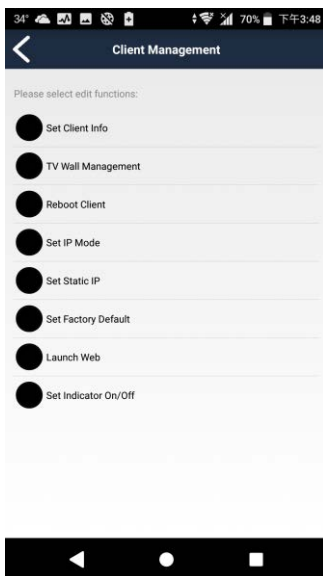

Touch "Set Client Info"

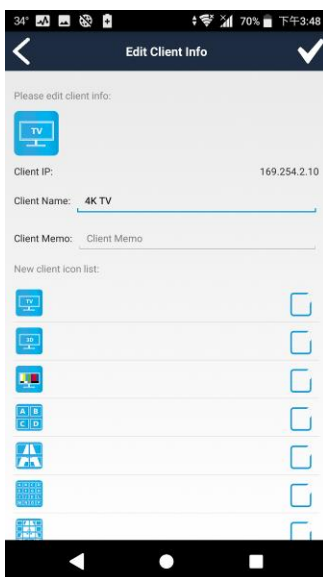

You can change the client name, memo and icon
Touch top right 「✓」 button to finish settings

Stream & Videowall Management 1.6 user manual for Android

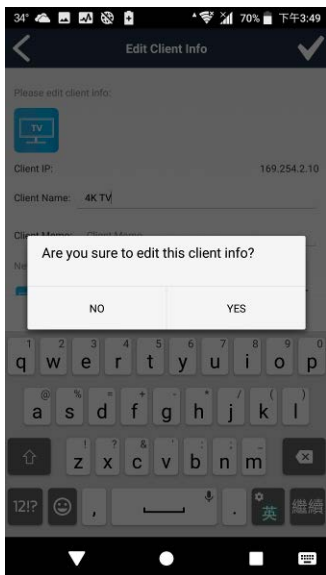

Touch 「Yes」 to confirm settings

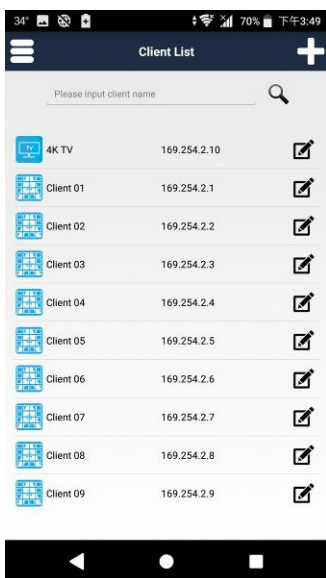

Return to the Client List. The client name or icon display the change.

Stream & Videowall Management 1.6 user manual for Android

Delete Client

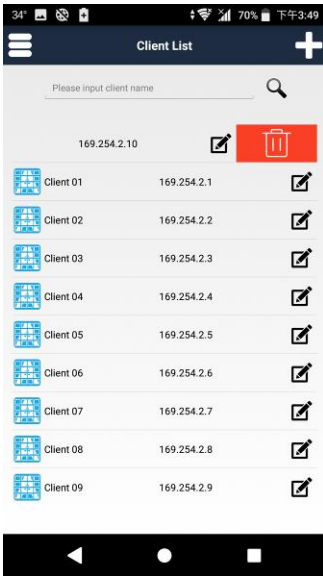

Drag client name at left to the trash can icon

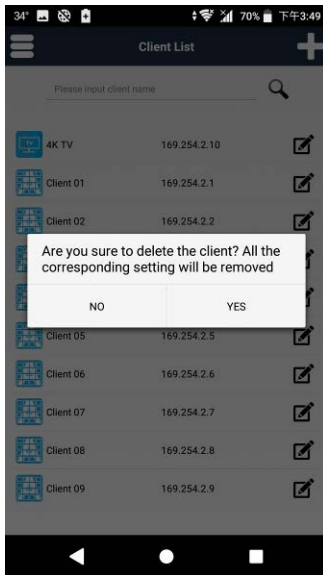

Touch 「Yes」 to confirm
All the corresponding settings will be removed

Stream & Videowall Management 1.6 user manual for Android

TV Wall Management

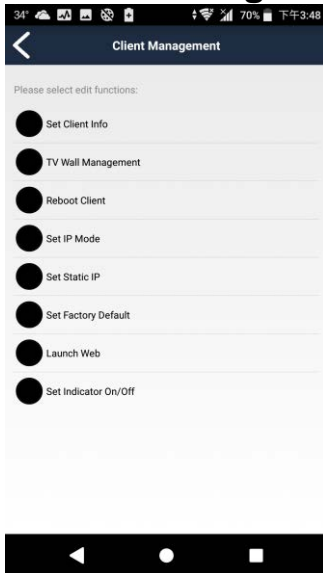

Touch TV Wall Management to enter Edit Client TV Wall page



You could select default layout as 1*1(single), 2*2, 3*3, 4*4 in the list at the bottom, then touch 「>」 icon

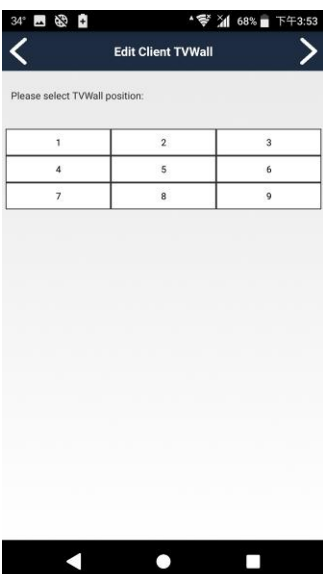

It will show the TV wall layout you selected

Stream & Videowall Management 1.6 user manual for Android

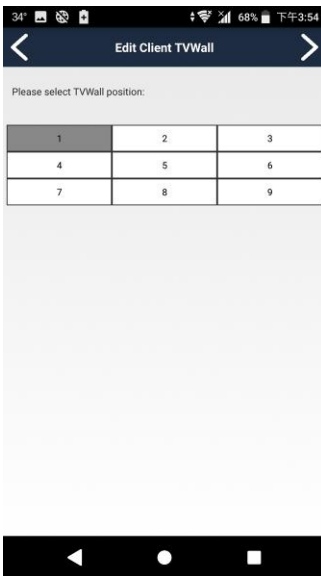

Choose the position of this monitor (RX) in the TV wall then touch 「>」 icon

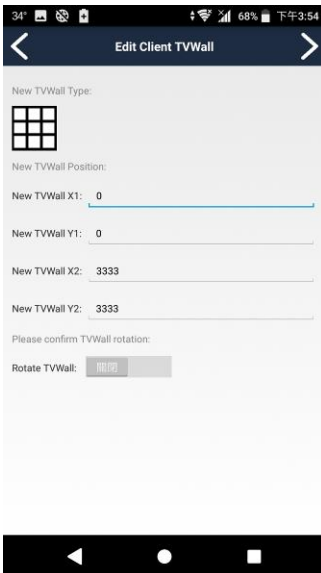

It will show detail coordinates and the size of the TV wall. Adjust the number if you want to shift the position.
After setting touch 「>」 icon



Touch 「Yes」 to confirm setting
You will see that the monitor has been changed to TV wall mode

Stream & Videowall Management 1.6 user manual for Android



Or you could set the columns and rows manually, with a maximum of 8 rows and 16 columns



Choose the position of this monitor (RX) in the TV wall then touch the 「>」 icon



It will show detailed coordinates and the size of the TV wall. Adjust the number if you want to shift the position or rotate the screen. After setting please touch > icon

Stream & Videowall Management 1.6 user manual for Android

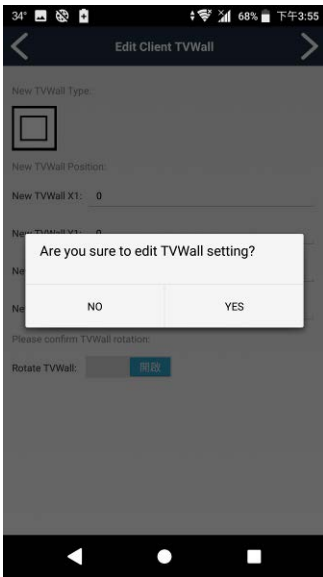

Touch 「Yes」 to confirm setting

You will see the monitor has been changed to TV wall mode

Stream & Videowall Management 1.6 user manual for Android

Reboot Client

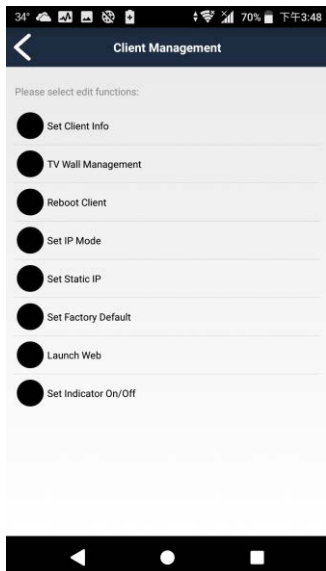

Touch "Reboot Client" to enter Reboot Client page

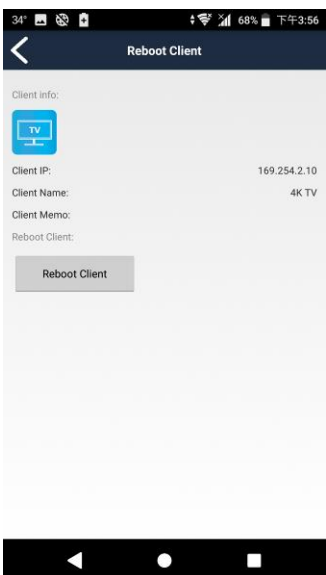

Touch 「Reboot Client」 to confirm setting

Stream & Videowall Management 1.6 user manual for Android

Set IP Mode

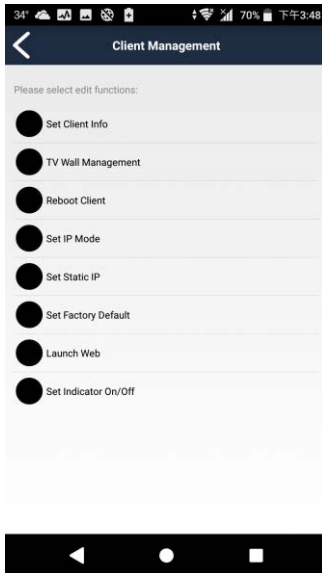

Touch "Set IP Mode" to enter Set IP Mode page

Auto Mode

IP is assigned by client itself as 169.254.x.x, however it will be changed automatically if a duplicate IP is detected.

DHCP Mode

IP address will be assigned by DHCP server

Notice: If there is no DHCP server the client will not able to work. You must reboot the client to renew the IP address once a DHCP server is available, or set the client to factory default using MENU function 333 to switch to Auto Mode

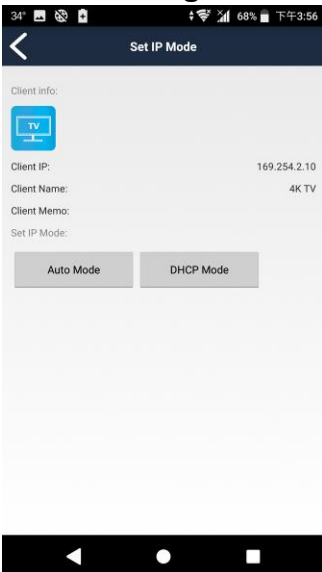

Touch 「Auto Mode」 or 「DHCP Mode」 to set IP mode

Stream & Videowall Management 1.6 user manual for Android

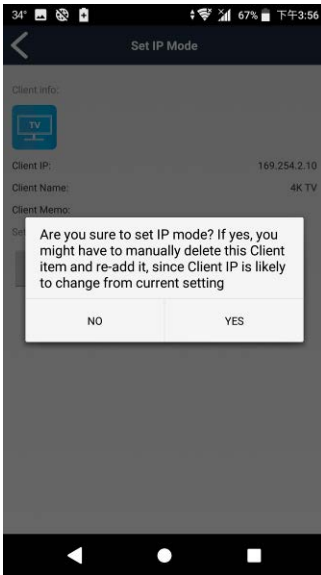

Touch 「Yes」 to confirm setting
Client will be reboot automatically

Static IP

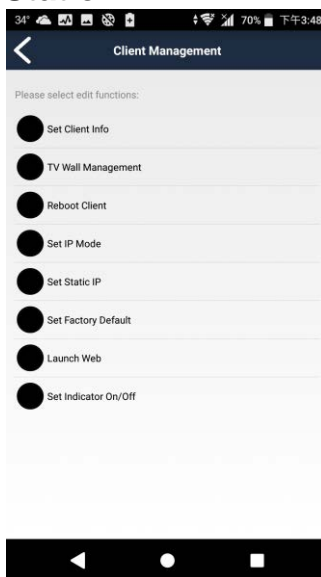

Touch "Set Static IP" to enter Set Static IP page

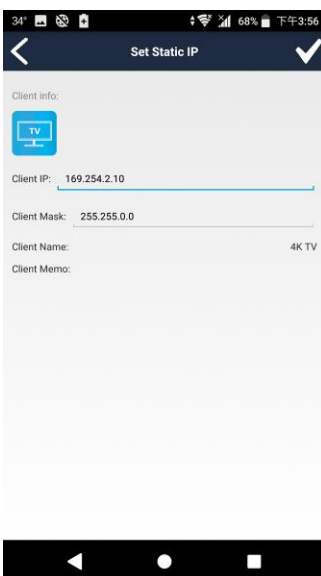

Enter IP address and subnet mask, then touch top right 「✓」 button to finish setting
The Client will be reboot automatically

Stream & Videowall Management 1.6 user manual for Android

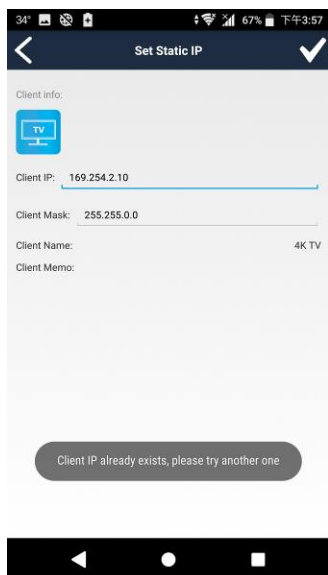

Notice: IP address must be unique (no duplicates) It will show a warning message (in image right) if the IP address already exists

Stream & Videowall Management 1.6 user manual for Android

Set Factory Default

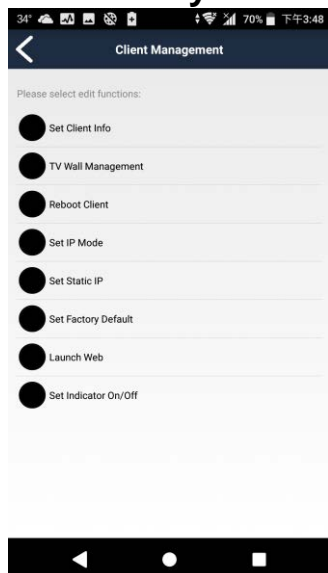

Touch "Set Factory Default" to enter Set Factory Default page

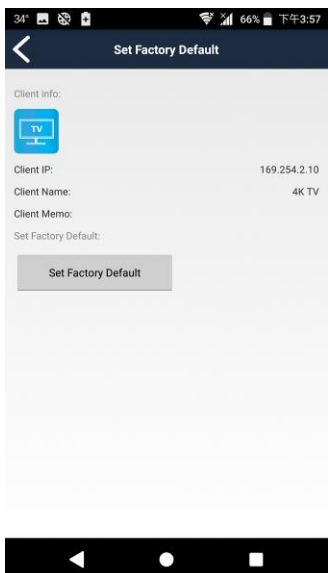

Touch "Set Factory Default "

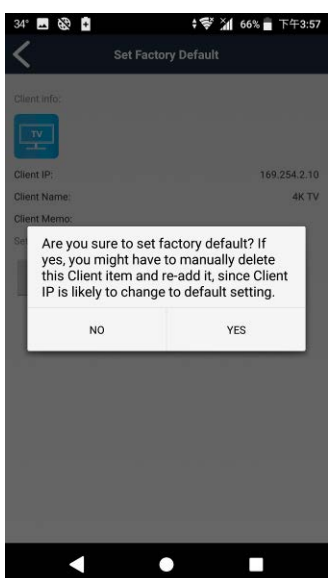

Touch 「YES」 to confirm
Client will be reboot automatically

Stream & Videowall Management 1.6 user manual for Android

Launch Web

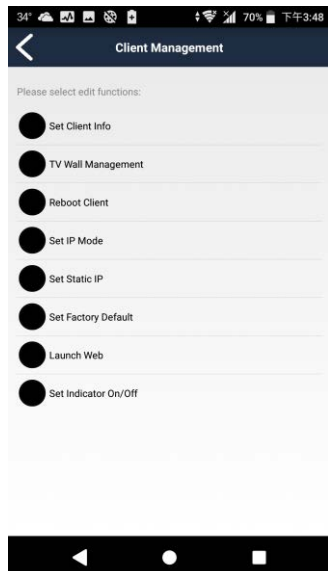

Touch "Launch Web" on the Client Management page

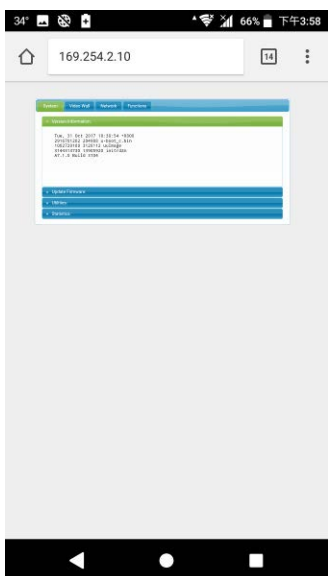

It will open a browser and login to the web interface of the client

For detailed settings please refer to the user manual

Stream & Videowall Management 1.6 user manual for Android

Indicator

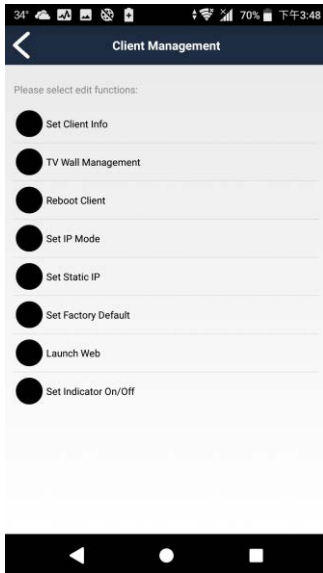

Touch "Set Indicator On/Off" to enter this setting page



Touch "Indicator On", the ON LED of the host will keep flashing and show an OSD message "I am here" on the monitor

Touch "Indicator Off" to stop indicating

Stream & Videowall Management 1.6 user manual for Android

Host Management

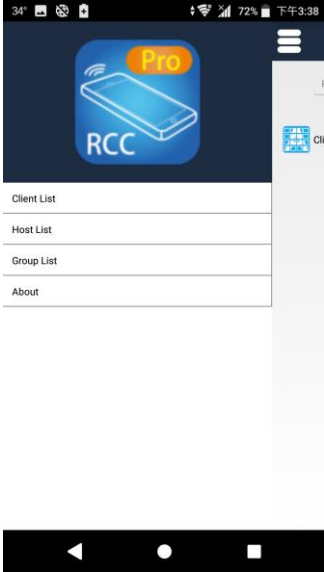

Touch the top right menu bar to show full menu
Touch the "Host List" to display available hosts

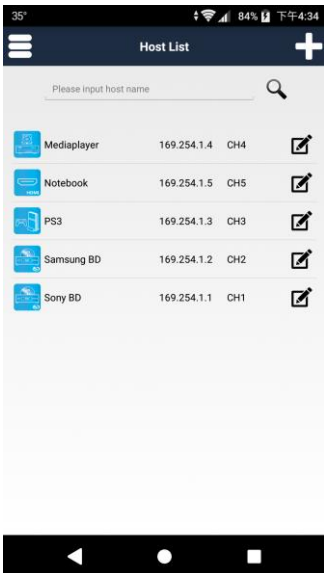

The list shows the status of registered hosts:

IP address: default is 169.254.xxx.xxx,
subnet mask 255.255.0.0
Channel number: 0~999

Preview Image

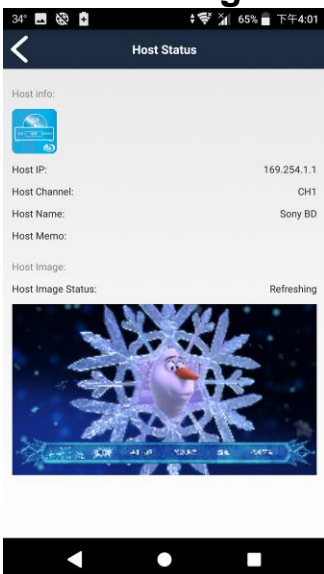

Touch host to preview the image from the source to make sure the content is correct before switching to it

The image will refresh automatically

Stream & Videowall Management 1.6 user manual for Android

Set Host Info

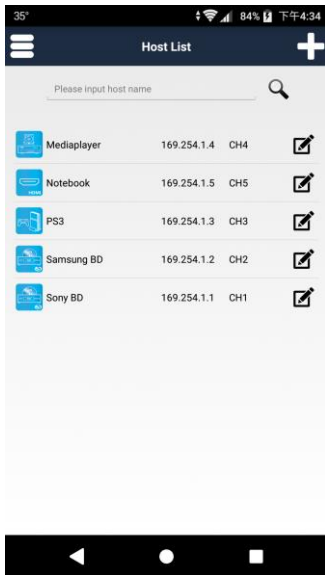

Touch right pencil icon in Host list to enter Host Management page

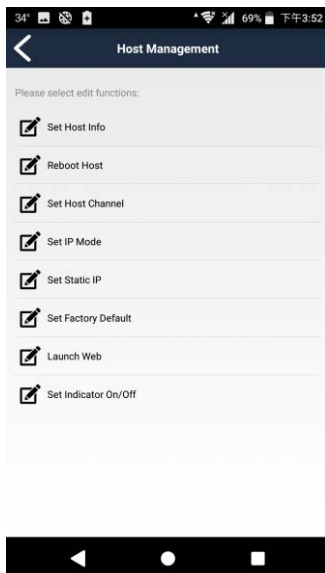

Touch "Set Host Info"

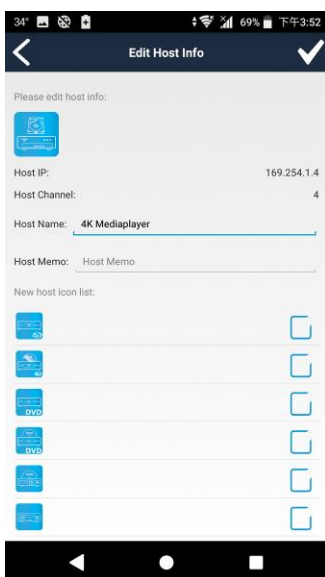

You can change the host name, memo and icon
Touch top right 「✓」 button to finish setting

Stream & Videowall Management 1.6 user manual for Android

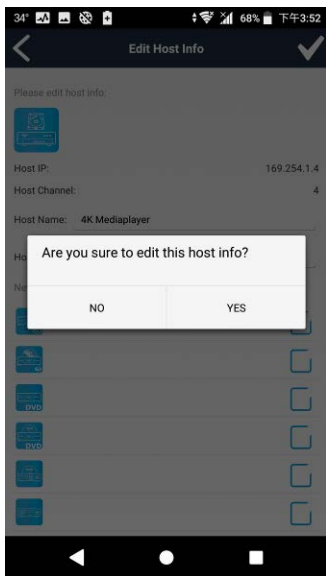

Touch 「Yes」 to confirm setting

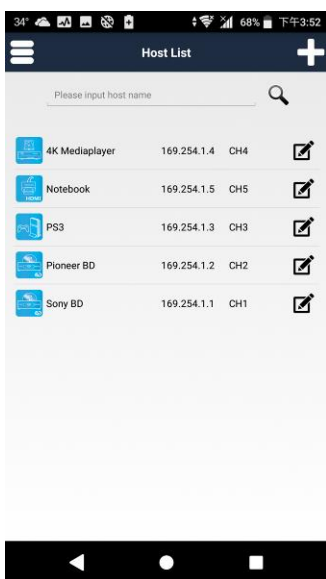

Returning to the Host List find that the host name or icon have been changed

Stream & Videowall Management 1.6 user manual for Android

Delete Host

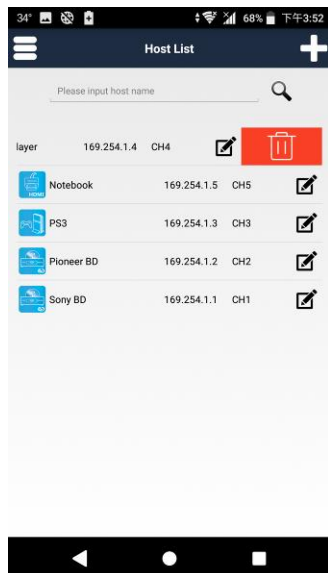

Drag host name at left to the trash can icon

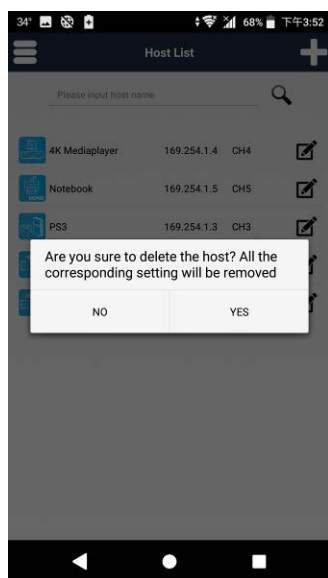

Touch 「Yes」 to confirm
All the corresponding settings will be removed

Stream & Videowall Management 1.6 user manual for Android

Reboot Host

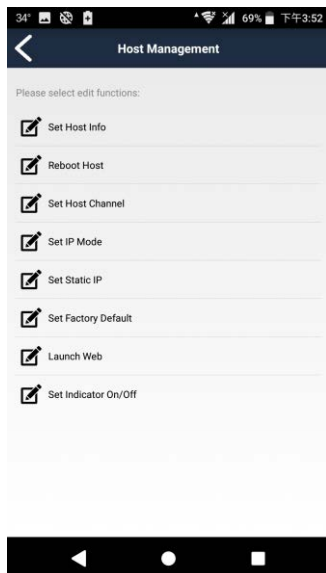

Touch "Reboot Host" to enter Reboot Host page

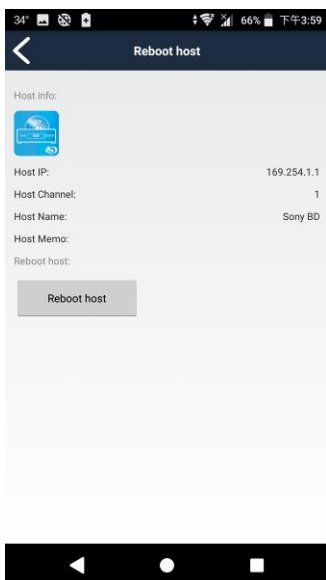

Touch 「Reboot Host」 to confirm the action

Stream & Videowall Management 1.6 user manual for Android

Set Host Channel

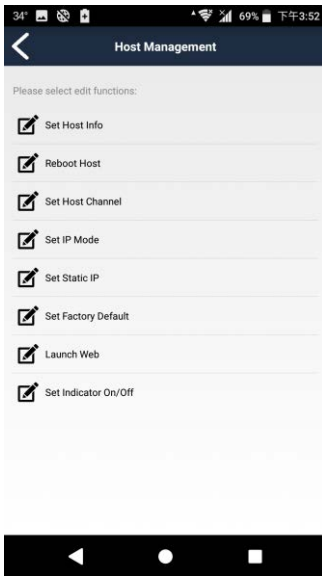

Touch "Set Host Channel" enter the settings page



Enter a channel number (0~999) to assign to the host
Then touch top right 「✓」 button to finish setting

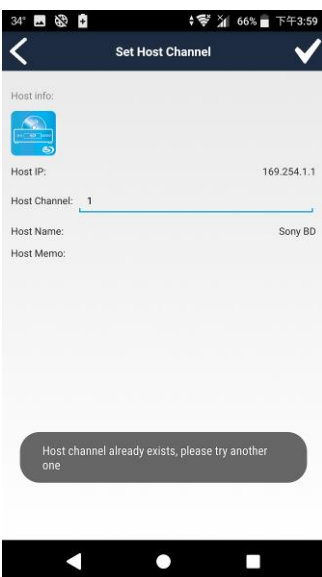

**Notice: Channel number must be unique and not duplicated
It will show warning message if the channel number already exists**

Stream & Videowall Management 1.6 user manual for Android

Set IP Mode

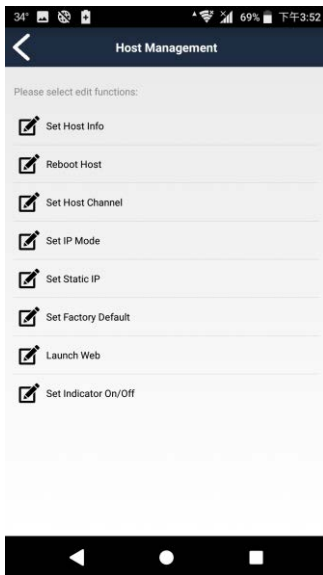

Touch "Set IP Mode" to enter Set IP Mode page

Auto Mode

IP assigned by host itself as 169.254.x.x, it will be changed automatically if a duplicate IP detected.

DHCP Mode

IP address will be assigned by a DHCP server

Notice: If there is no DHCP server the host will not be able to work. You must reboot the client to renew its IP address once the DHCP server becomes available, or set the host to factory default using MENU function 333 to switch back to Auto Mode

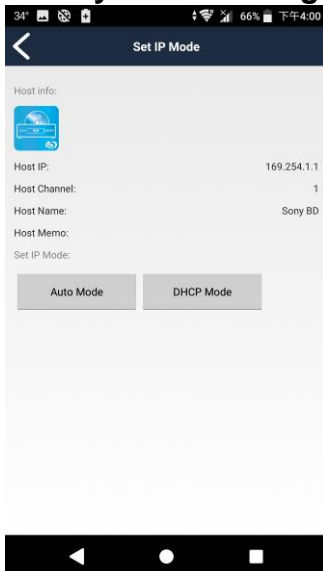

Touch 「Auto Mode」 or 「DHCP Mode」 to set IP mode

Stream & Videowall Management 1.6 user manual for Android

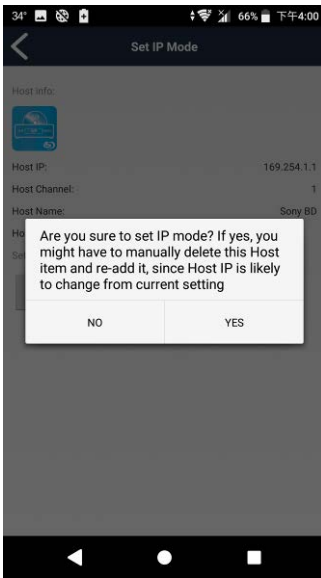

Touch 「Yes」 to confirm setting
Host will be rebooted automatically

Static IP

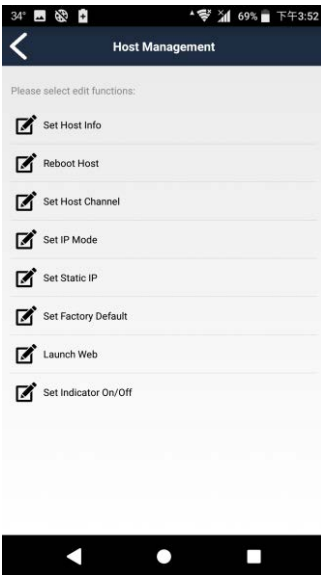

Touch "Set Static IP" to enter Set Static IP page

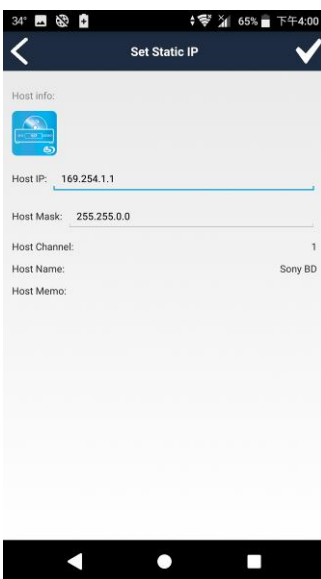

Enter the IP address and subnet mask, then touch top right 「✓」 button to finish settings

The Host will be rebooted automatically

Stream & Videowall Management 1.6 user manual for Android

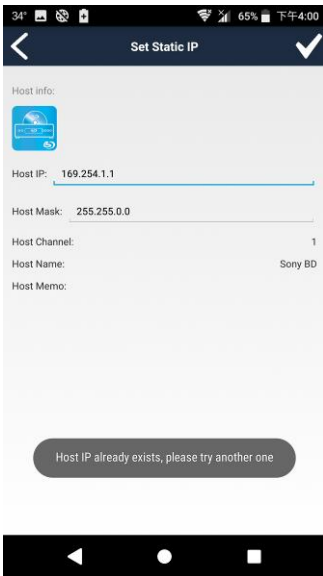

**Notice: IP address must be unique (no duplicates)
It will show warning message if the IP address already exists**

Stream & Videowall Management 1.6 user manual for Android

Set Factory Default

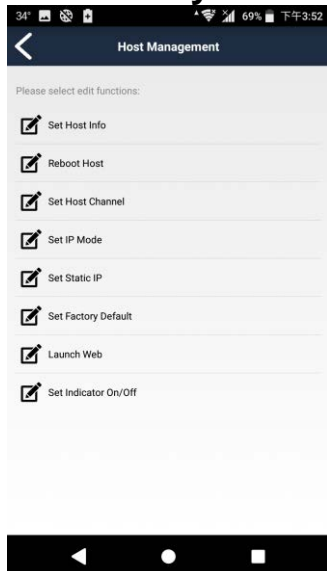

Touch "Set Factory Default" to enter setting page

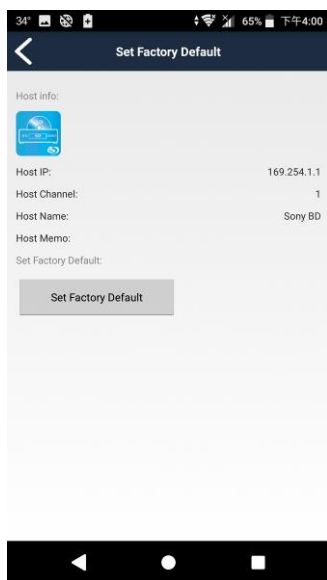

Touch "Set Factory Default"

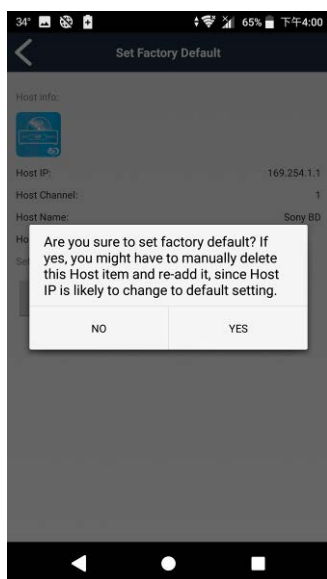

Touch 「YES」 to confirm
The Host will be rebooted automatically

Stream & Videowall Management 1.6 user manual for Android

Launch Web

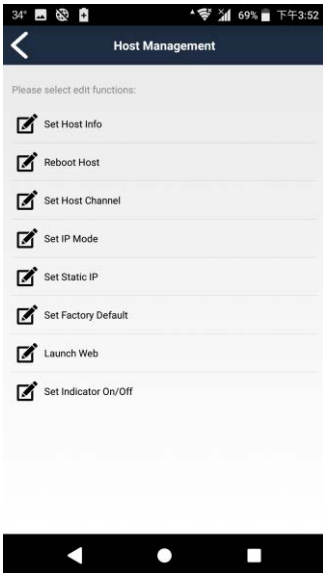

Touch "Launch Web"



It will open a browser and login to the web interface of the host

For detailed settings please refer to the user manual

Stream & Videowall Management 1.6 user manual for Android

Indicator

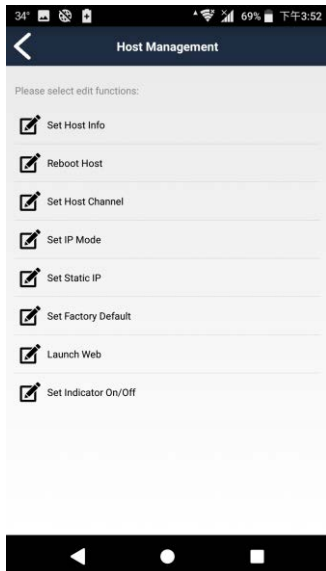

Touch "Set Indicator On/Off" to enter this setting page

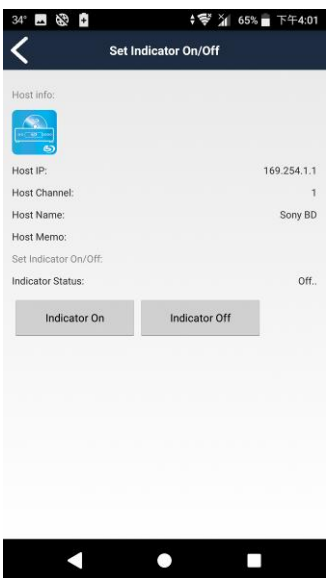

Touch "Indicator On", the "ON" LED of the host will keep flashing

Touch "Indicator Off" to stop indicating

Stream & Videowall Management 1.6 user manual for Android

Group Management Create Group

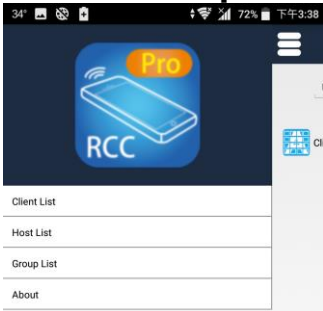

Touch top left menu bar to show the menu

Touch "Group List" to open Group List page



Touch top right 「+」 to enter Add Group page



Enter the group name and memo

Notice: Group name must be unique (no duplicates)

Stream & Videowall Management 1.6 user manual for Android

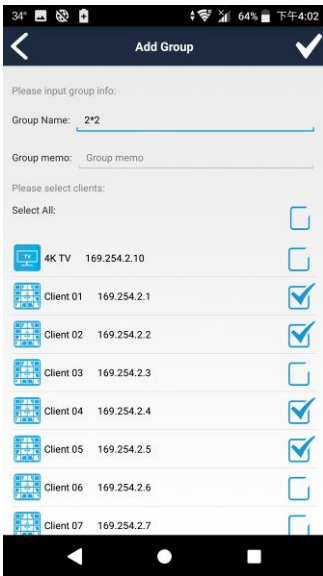

Select the clients you want in that group

Touch top right 「✓」 button to finish setting.

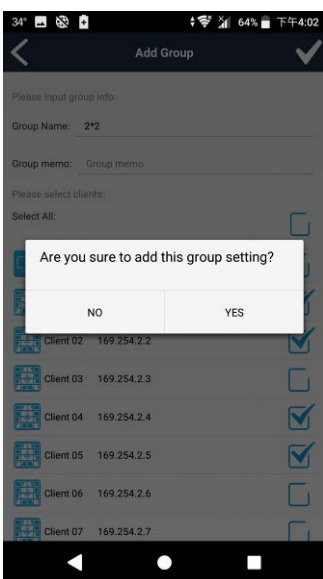

Touch 「Yes」 to confirm setting

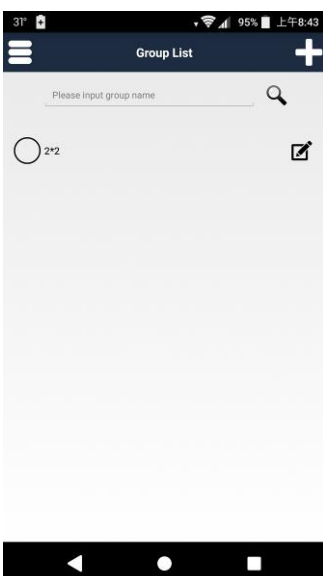

Return to Group List page to see the group you just added.

Stream & Videowall Management 1.6 user manual for Android

Select Group Channel

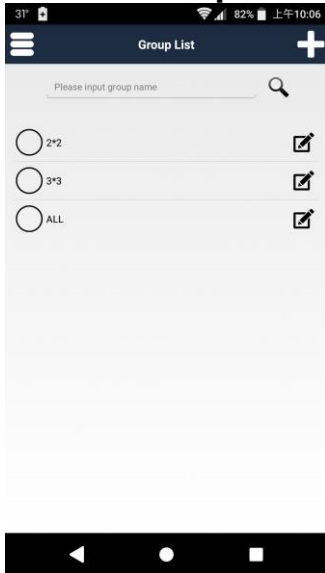

Touch group name column to enter the Group Source page

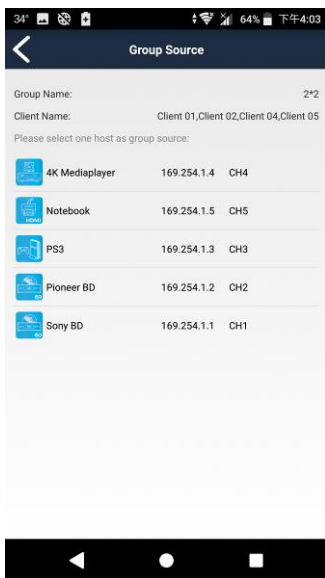

In the Group Source page will a list of all registered hosts for selection

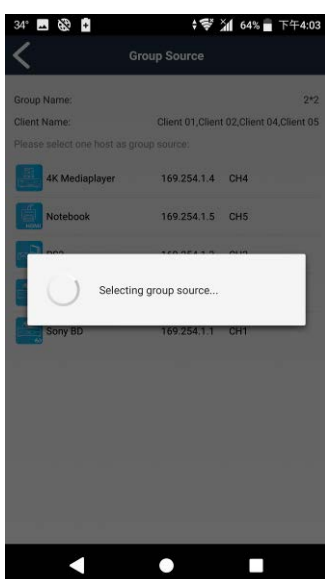

Touch the host icon to select it

The selected channel will be switched to immediately

Stream & Videowall Management 1.6 user manual for Android

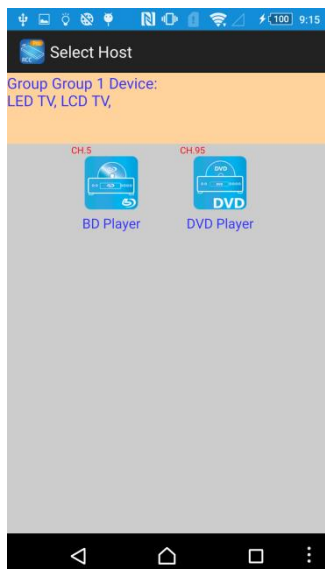

Yellow area shows the clients within the group

Gray area shows the available host channels



Touch the host icon to select it

The selected channel will be highlighted and switch that source to the screen immediately

Stream & Videowall Management 1.6 user manual for Android

Edit Group Info



Touch right pencil icon in the Group list to enter Edit Group Info page

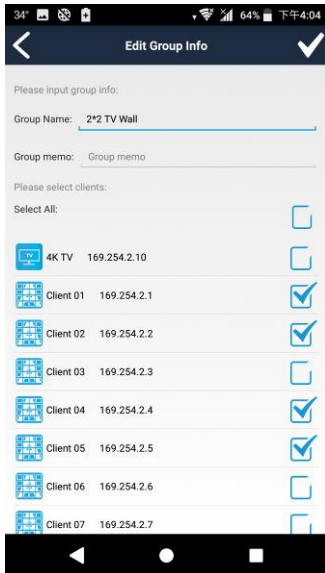

You can change group name, memo and add/remove clients
Touch top right 「✓」 button to finish setting

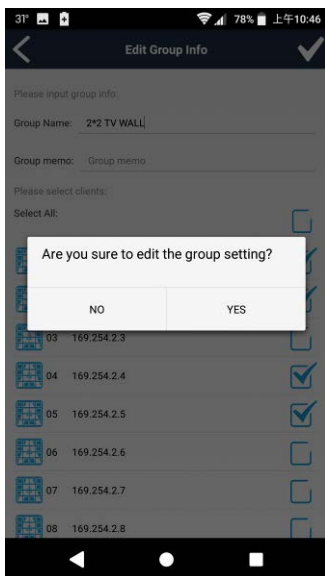

Touch 「Yes」 to confirm setting

Stream & Videowall Management 1.6 user manual for Android



Return to the Group List to see the group name has been changed (if you changed the group name)

Delete Group



Drag group name at left to the trash can icon

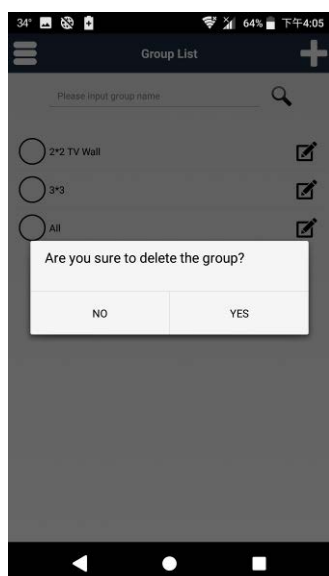

Touch 「Yes」 to confirm and the group will be removed